

## ESS LINK Batch Import Device Guide

This guide is designed to help you understand and correctly use this function. Please read this guide carefully before use and follow the instructions.

### 1. Download the template

The table template for importing equipment must be downloaded from ESS LINK. The downloading steps are as follows:

Click **【Admin.】** -> **【Add New Site】** -> **【Add Existing Site】** -> **【Import Template Download】**, pull down to select the template type you want to import, and then click "Download" to save the template to local computer.

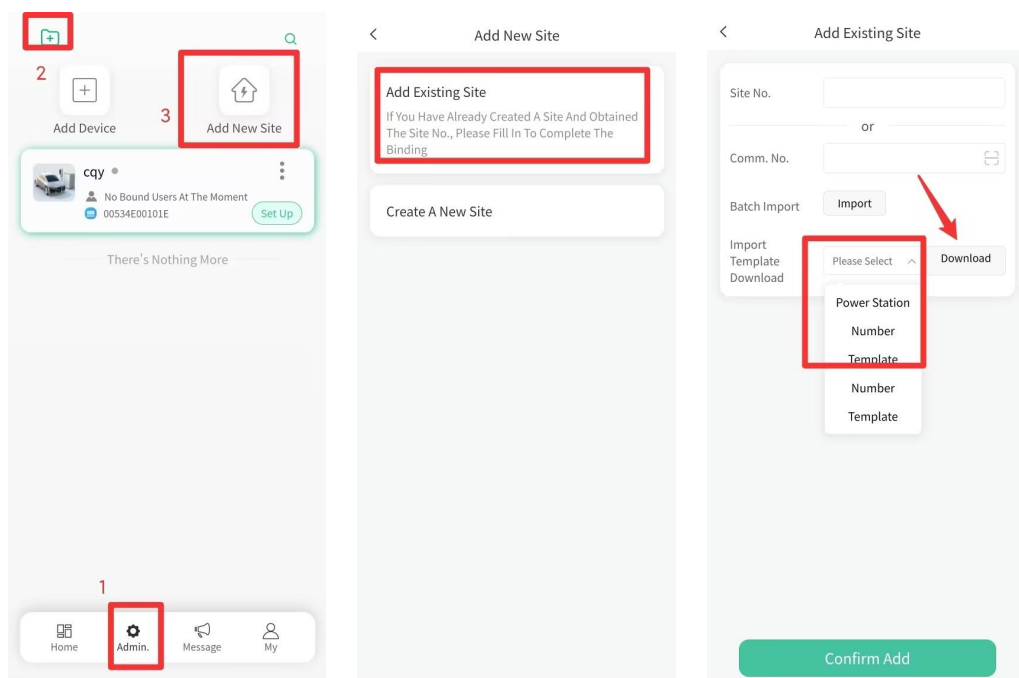

	A	B	C	D	E	F	G
1	DeviceSn						
2							
3							
4							
5							
6							
7							
8							

## 2. Fill in the template

The sub-maintainer shall fill in the communication codes or site codes of all device bound to his account into the template form as required, and send the form to the sup-maintainer.

	A	B	C	D	E	F
1	DeviceSn					
2	00534E0011EA					
3	00534E001178					
4						
5						
6						
7						
8						

## 3. Import template

After the sup-maintainer saves the completed form locally, enter ESS LINK, click **【Admin.】** -> **【Add New Site】** -> **【Add Existing Site】** -> **【Batch Import】** , select the saved template form to import, and click **【Confirm Add】** to save the settings. All devices in the list can be bound to this maintainer account.

