

# Installation Instructions

**Single phase HV Hybrid Inverter - Isuna D5K-SH~D12K-SH**

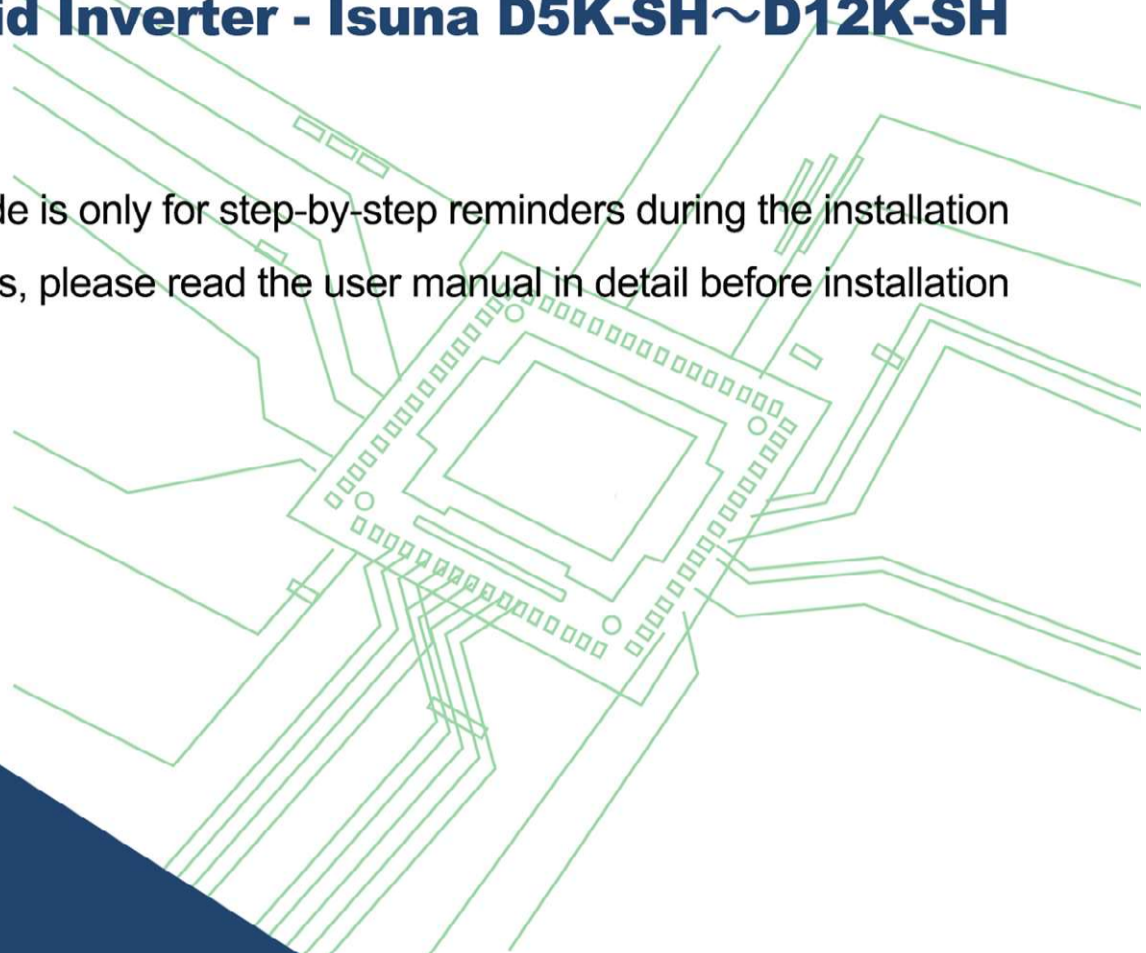

This guide is only for step-by-step reminders during the installation process, please read the user manual in detail before installation



## Installation Tool



Percussion drilling:  
wall drilling

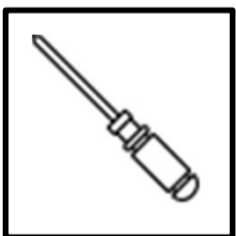

M6 Phillips screwdriver:  
Remove, install screws and  
wire connections

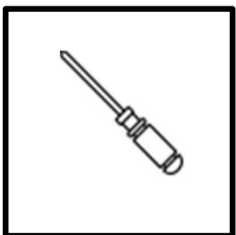

M4 Phillips screwdriver:  
Remove and install load  
terminal screws

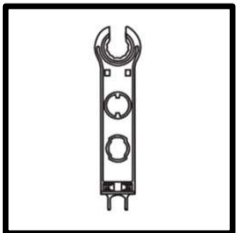

Removing tool:  
Remove the PV and  
BAT terminals



Wire stripper:  
Strip cables

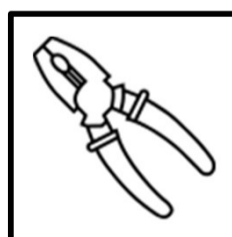

Crimping pliers:  
crimp PV and BAT cables

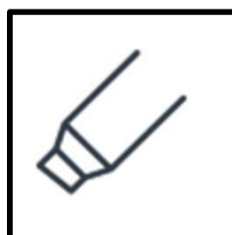

Marker:  
Punch mark



Tape measure:  
Measure distance

## Electrical Connection Diagram

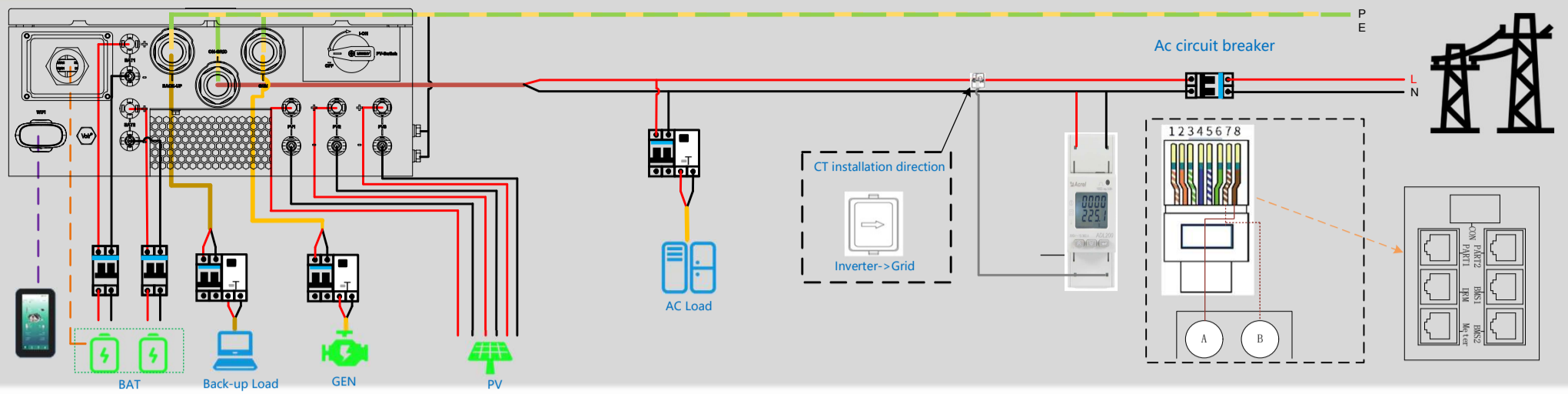

## Installation of wall mounts and inverters

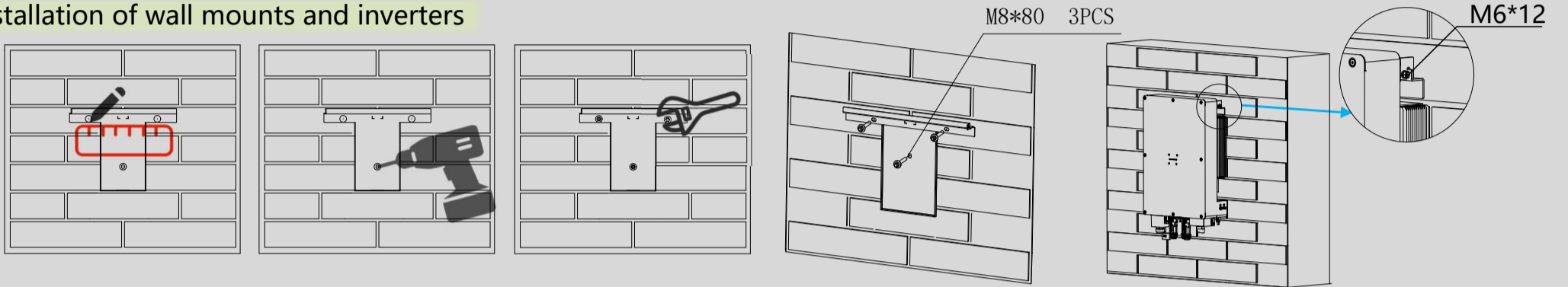

## Connecting the Ground protection cable (PE)

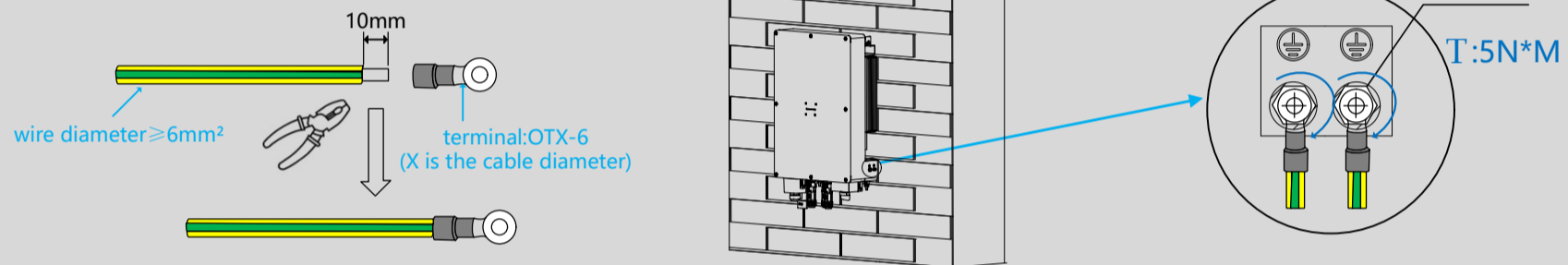

## Connecting the Battery and PV

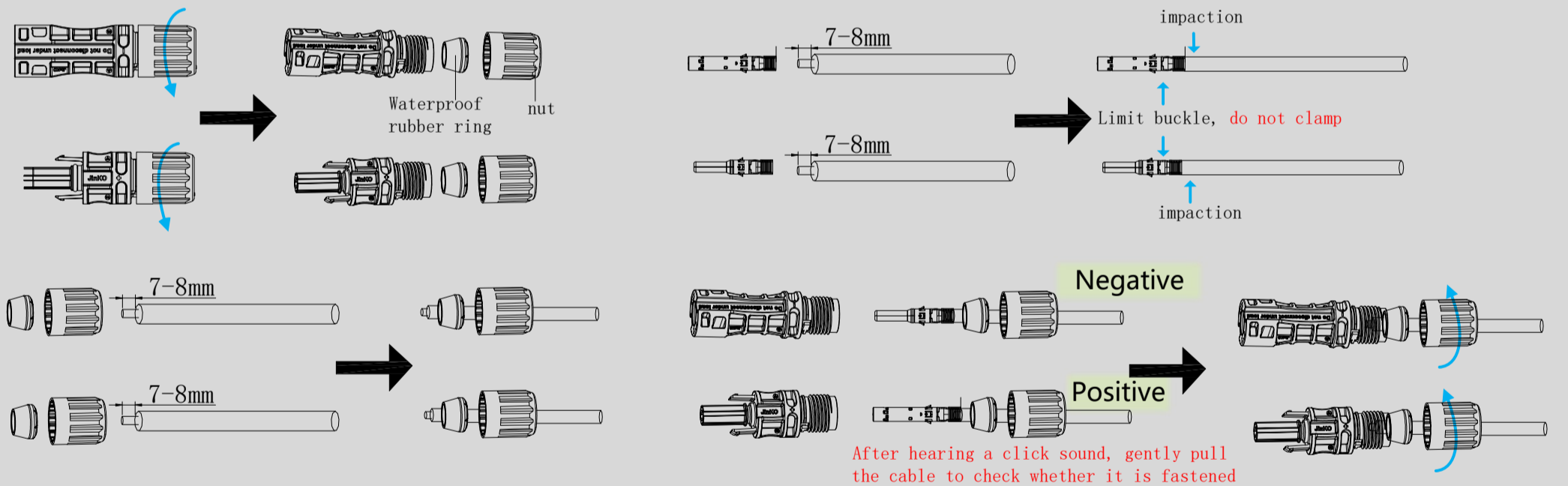

## Connecting AC grid-connected &amp; Load &amp; Diesel generator cables

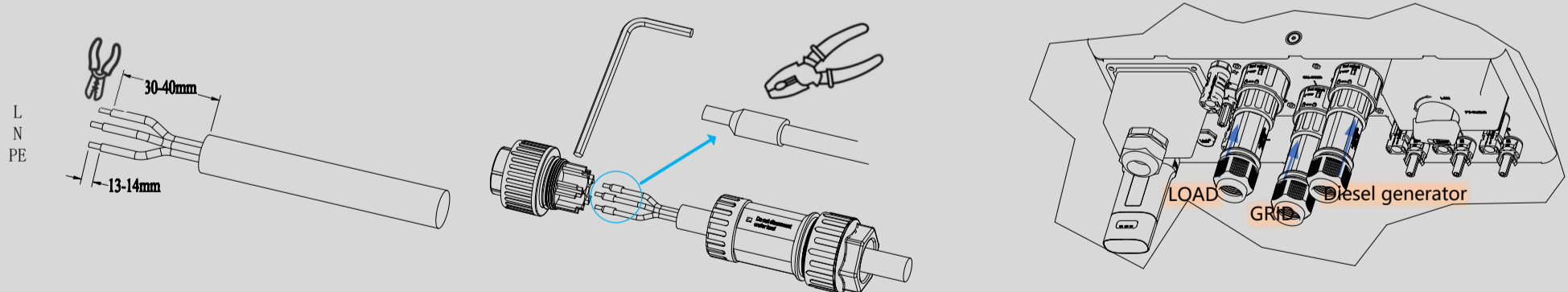

## Connecting the WIFI module

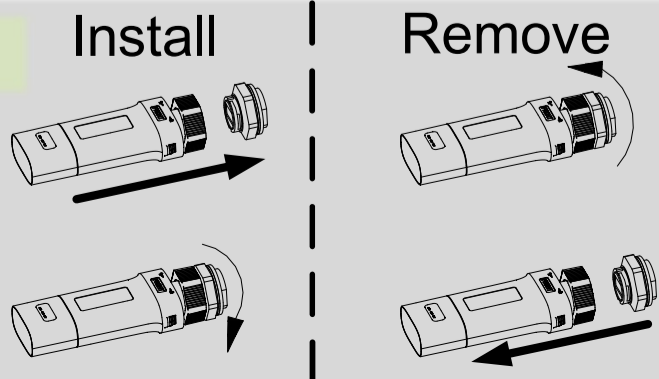

## ESS Link Download



Android



Google play



iOS

Download the user manual for details:  
[www.sinexcel-isuna.com/Download/](http://www.sinexcel-isuna.com/Download/)