

Installation Instructions

Single phase LV Hybrid Inverter - Isuna D5K-SL(-S)~Isuna D12K-SL(-S)

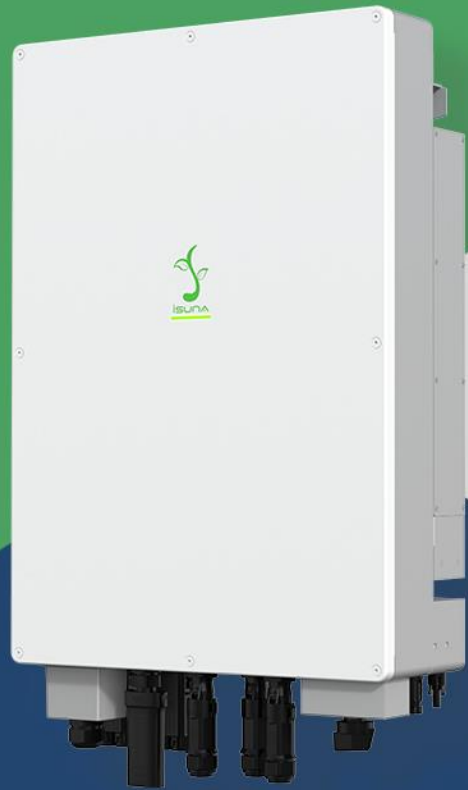

This guide is only for step-by-step reminders during the installation process, please read the user manual in detail before installation

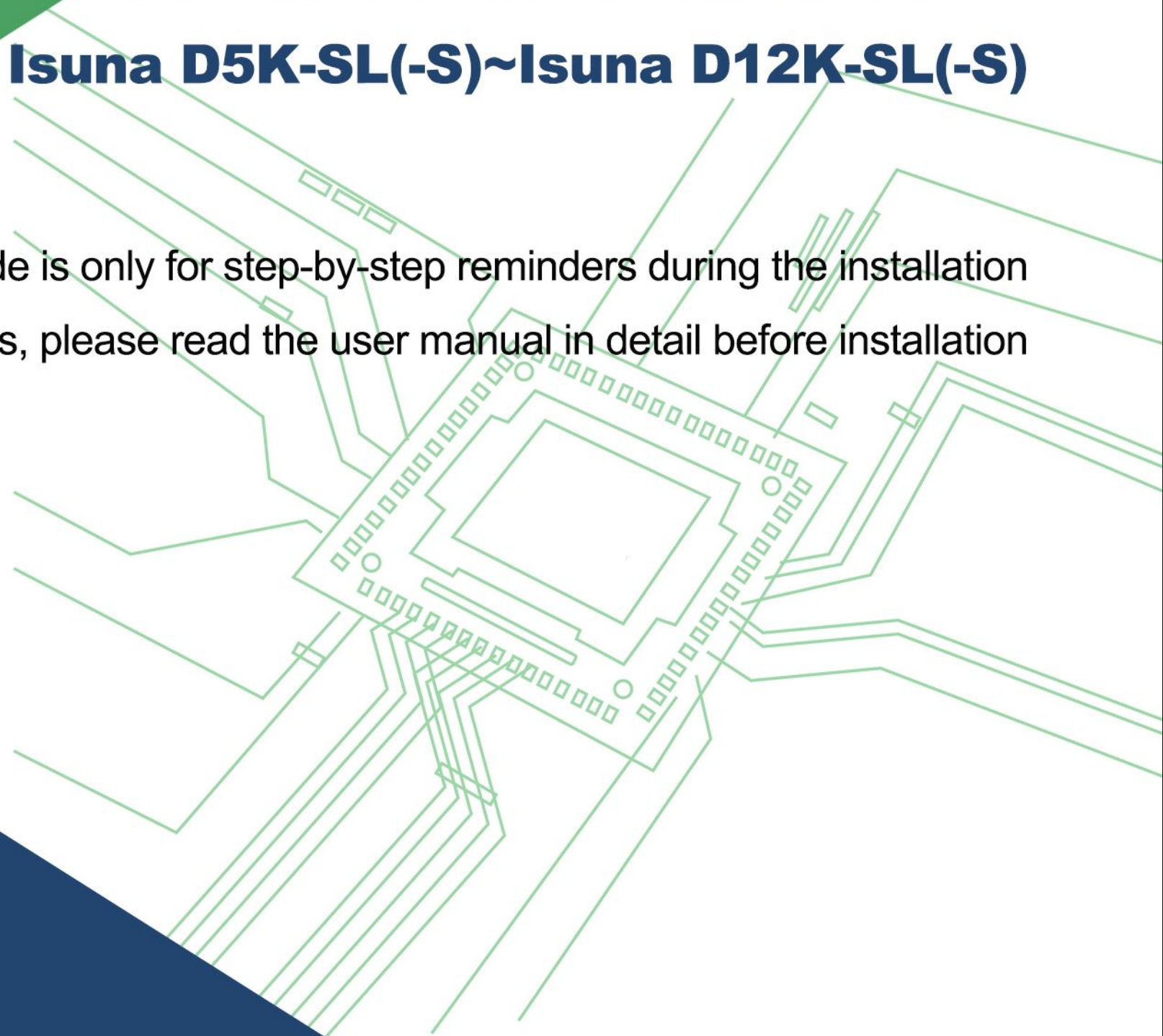

Installation Tool

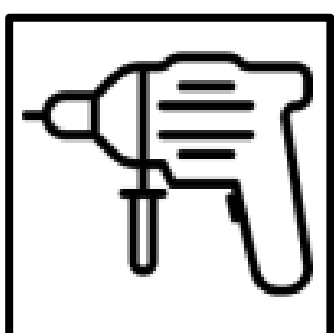

Percussion drilling: wall drilling



M6 Cross electric screwdriver: Remove, install screws and wire connections

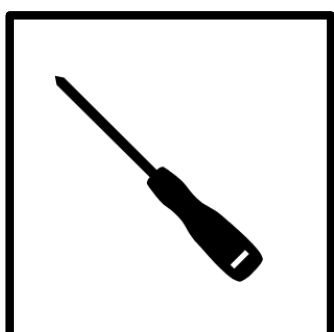

M3 Phillips screwdriver: Remove and Install BAT terminal cover screws

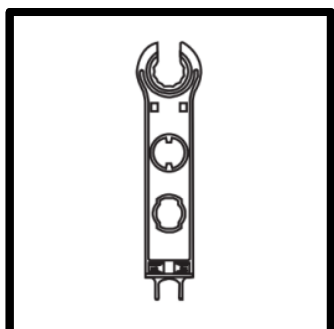

Removing tool: Remove the PV terminals

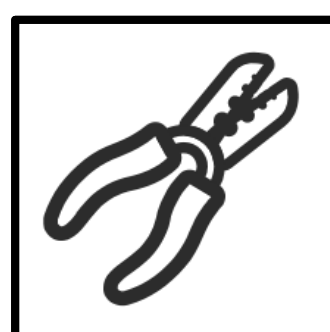

Wire stripping pliers: wire stripping

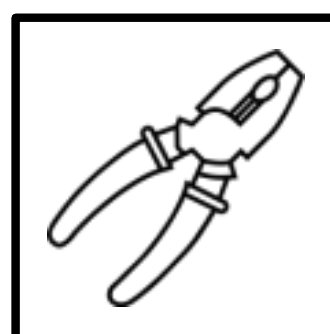

Wire crimping pliers: crimping PV and BAT cables

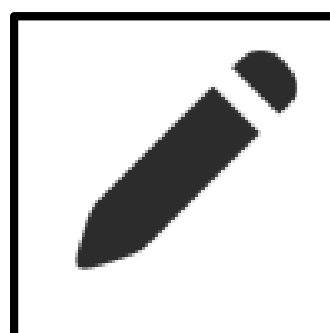

Marking pen: punching marks

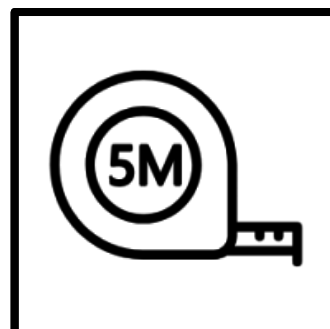

Tape measure: measuring distance

Electrical Connection Diagram

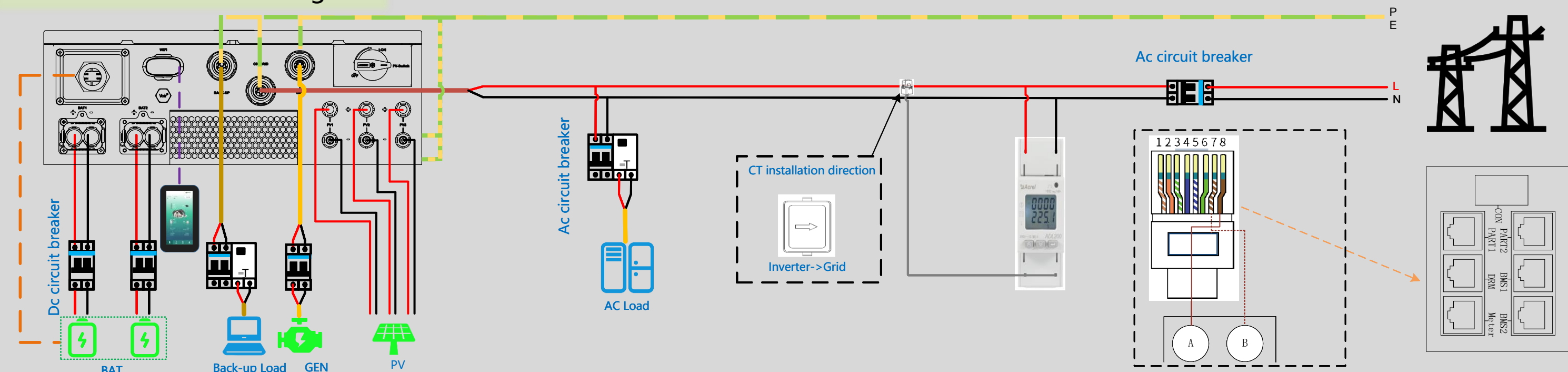

Installation of wall mounts and inverters

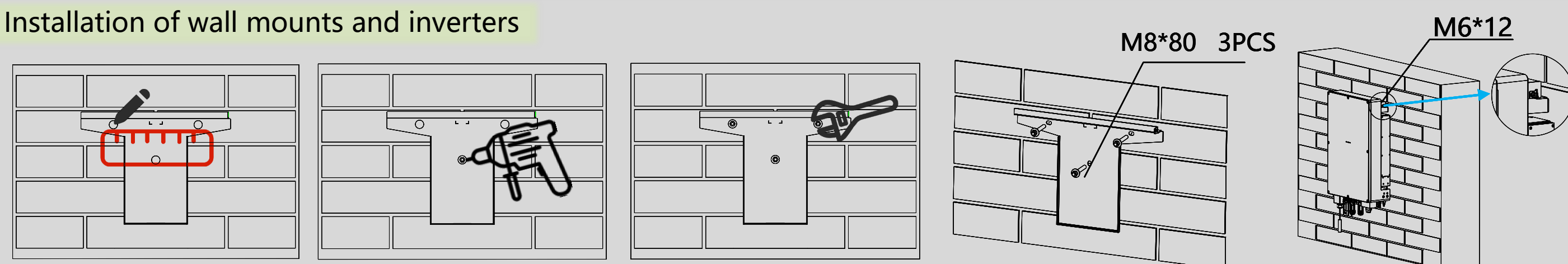

Connecting the Ground protection cable (PE)

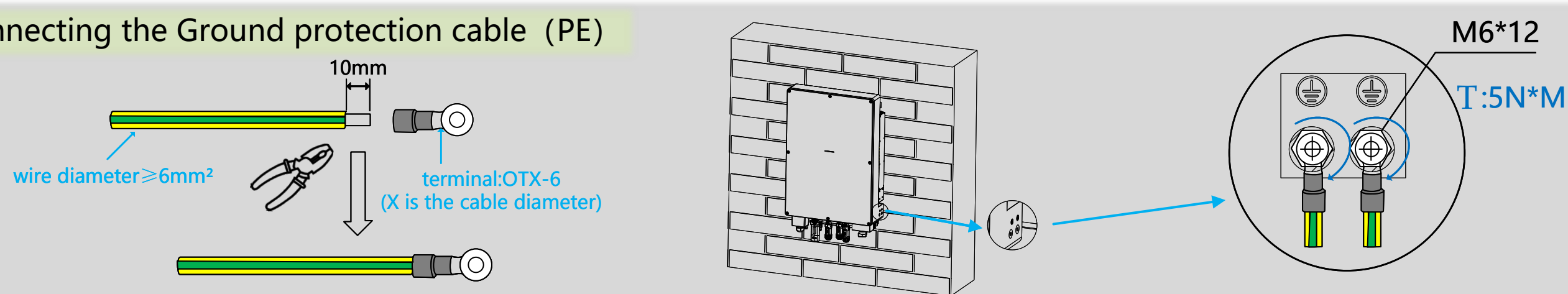

Connecting the Battery and PV

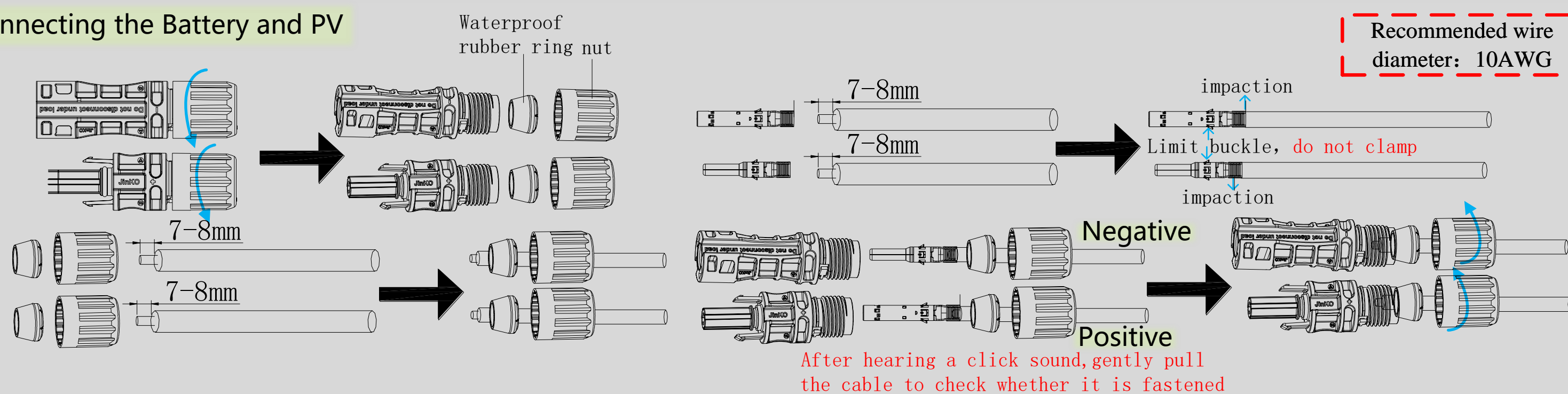

Recommended wire diameter: 2AWG

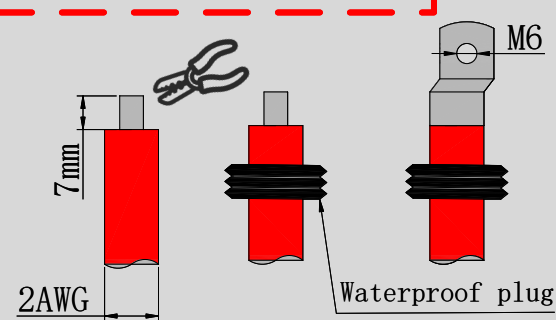

M6 2PCS

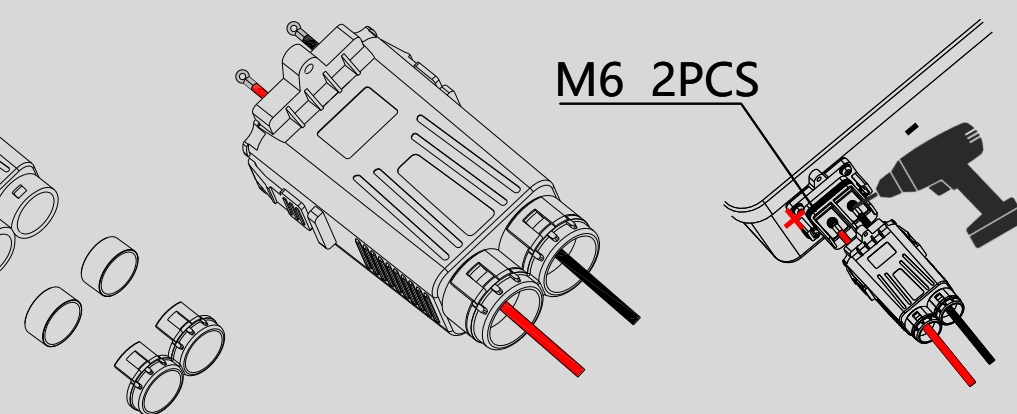

Avoid incorrect connection between positive and negative !!!

Connecting AC grid-connected & Load & Diesel generator cables

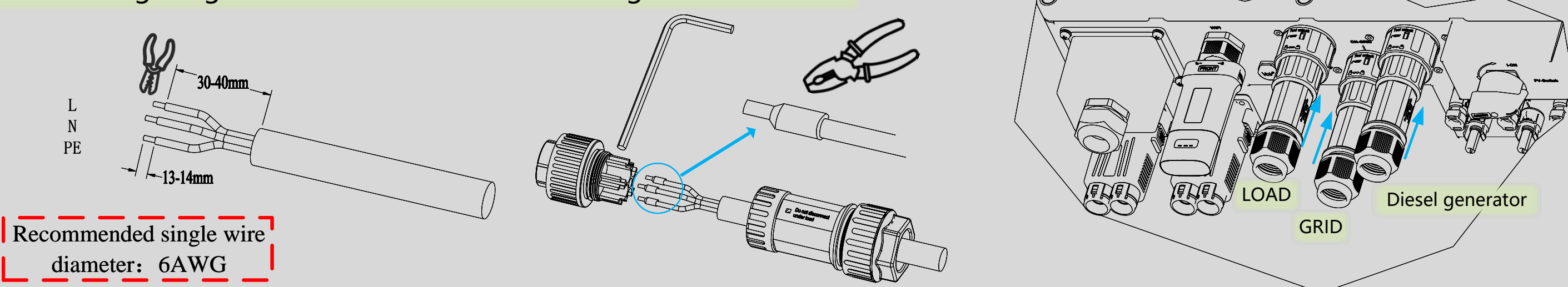

Connecting the WIFI module

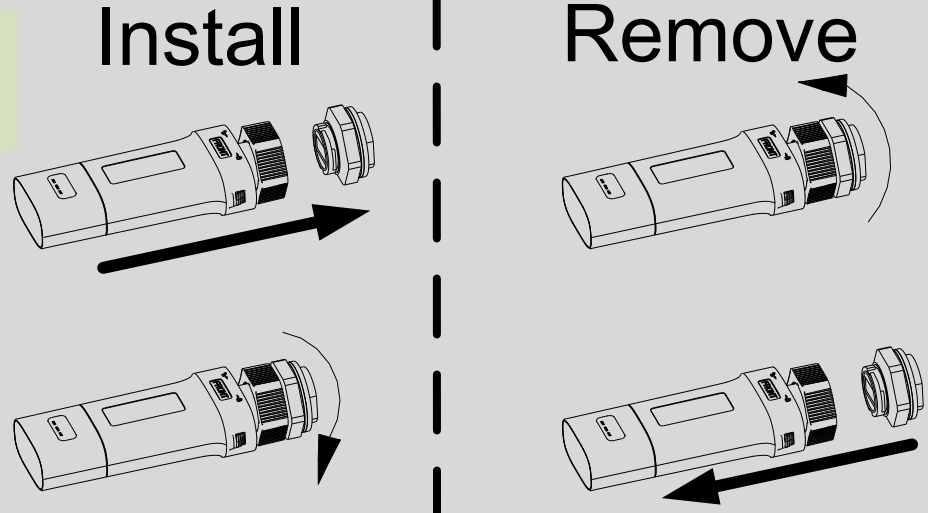

ESS Link Download



Android



Google play



iOS

Download the user manual for details:
www.sinexcel-isuna.com/Download/