

# Installation Instructions

## Single Phase LV Hybrid Inverter Isuna S3K-SL-S~S6K-SL-S

This guide is only for step-by-step reminders during the installation process, please read the user manual in detail before installation

### Mounting tools



Electric drill: for drilling holes in walls.

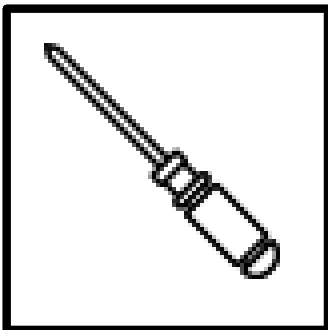

M6 screwdriver: Removal and installation of screws and wiring.

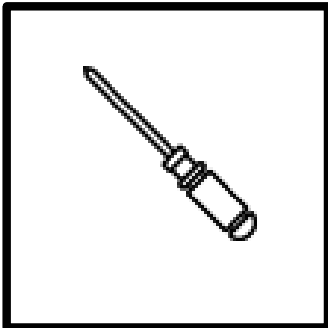

M4 screwdriver: Removal and installation of screws and wiring.

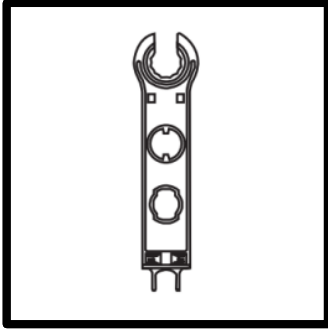

Removal tool: Remove and install the PV terminal.

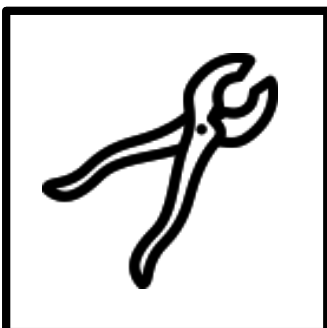

Wire strippers: Strip wires.

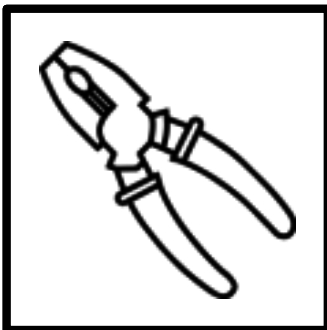

Crimping pliers: Crimp PV, BAT cable wires.

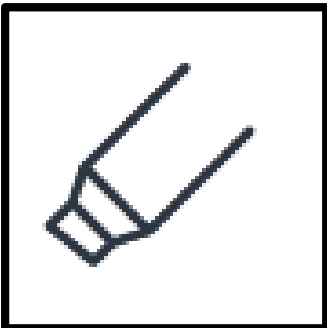

Marker: Punch marking.



Tape measure: Measuring distances.



Electrical Connection Diagram

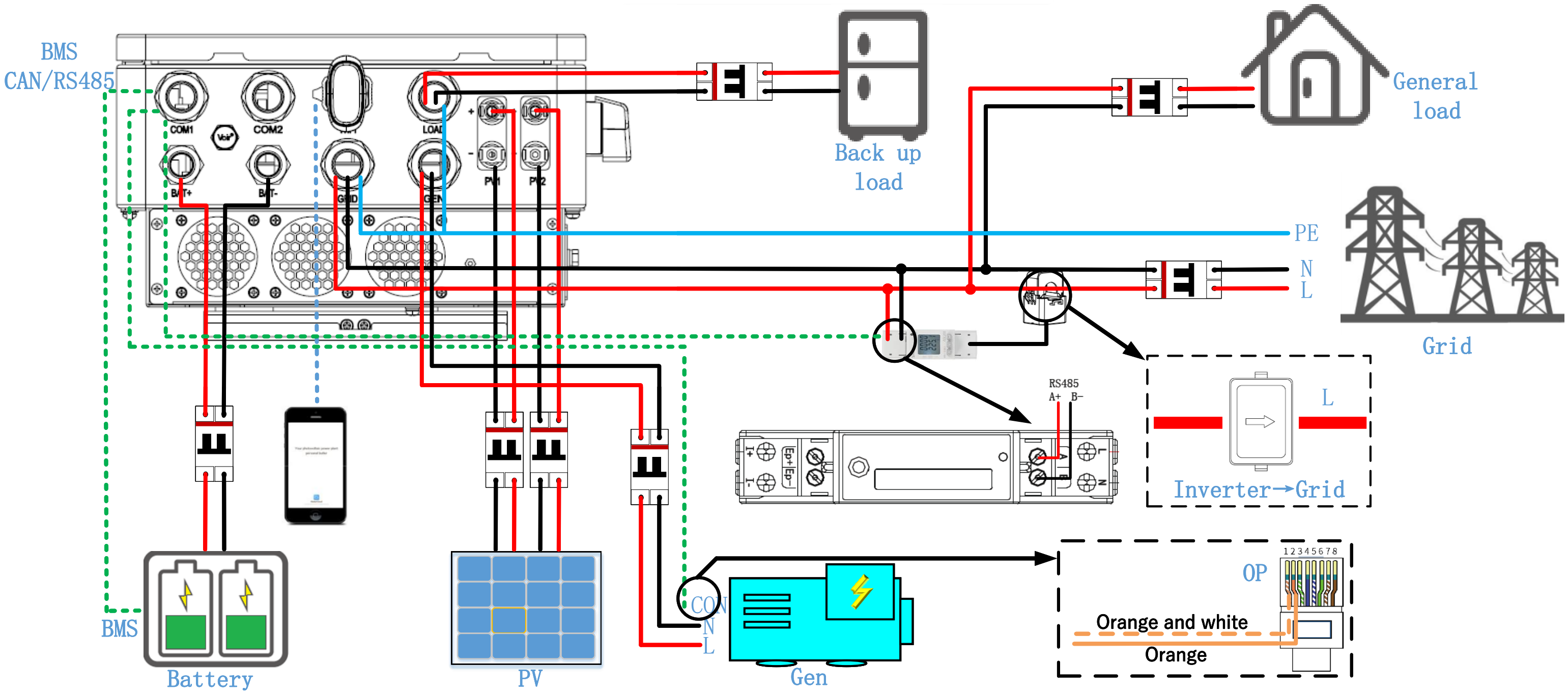

Installation of wall mounts and inverters

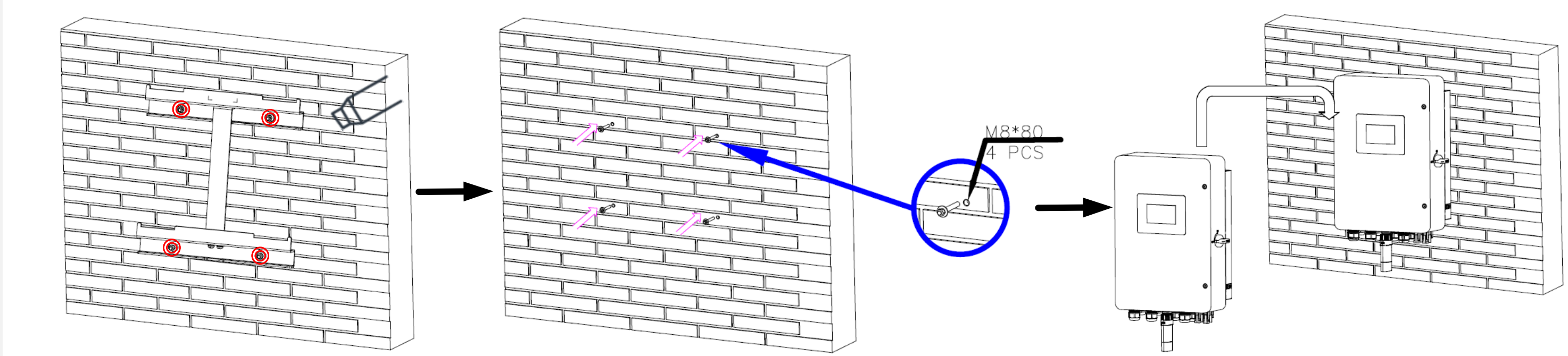

Connecting the battery

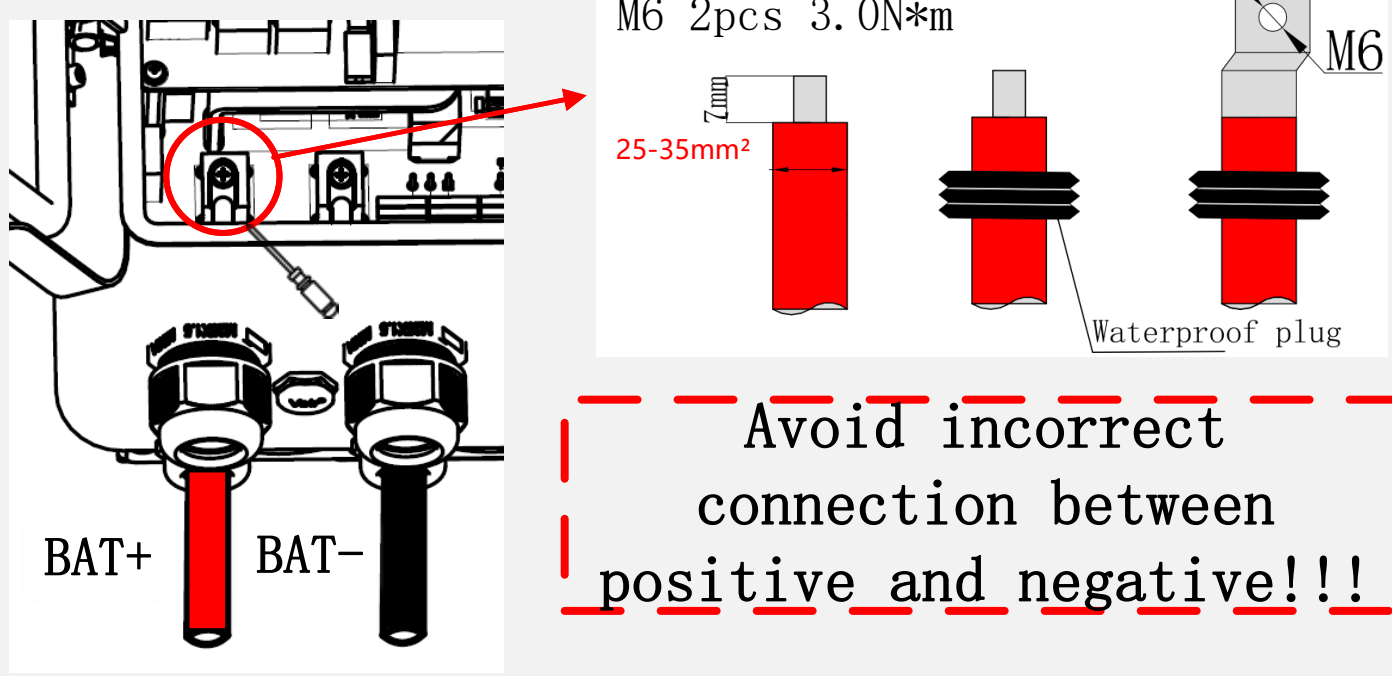

Connecting the AC Terminal

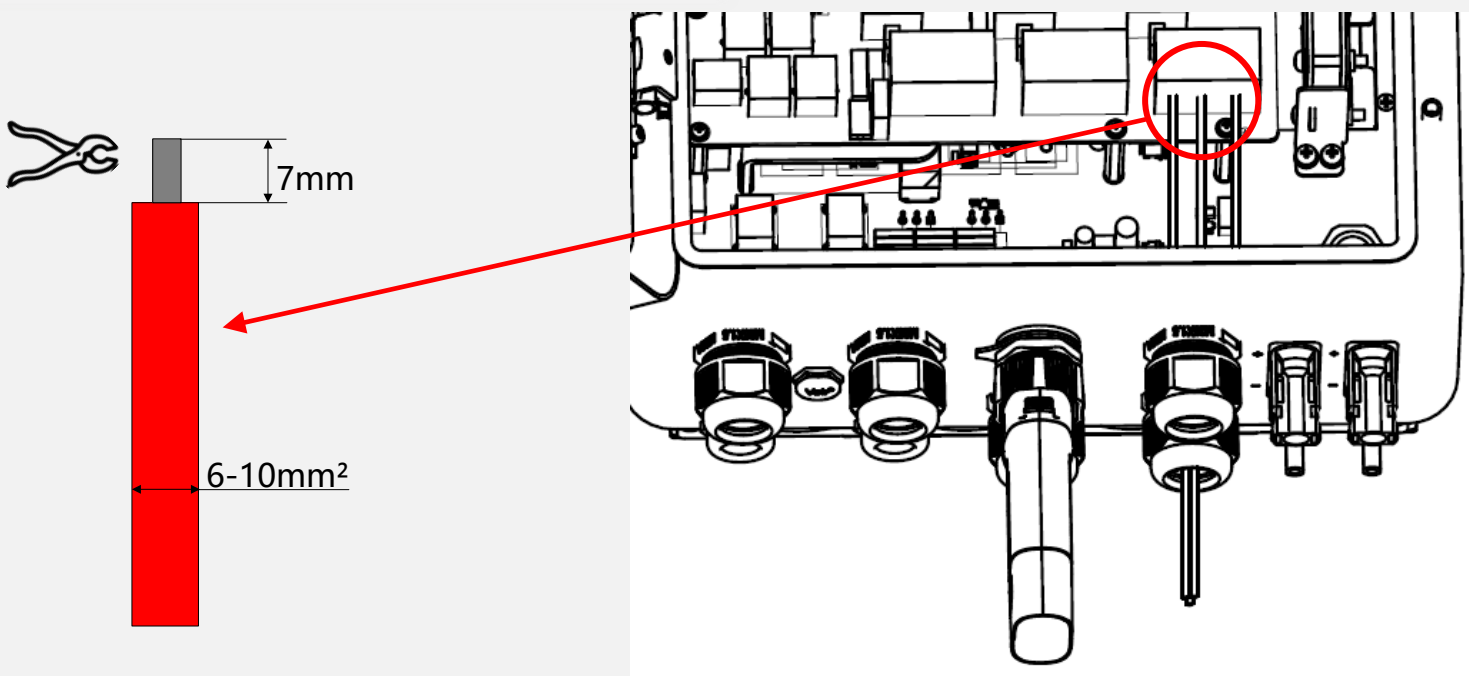

Inverter grounding

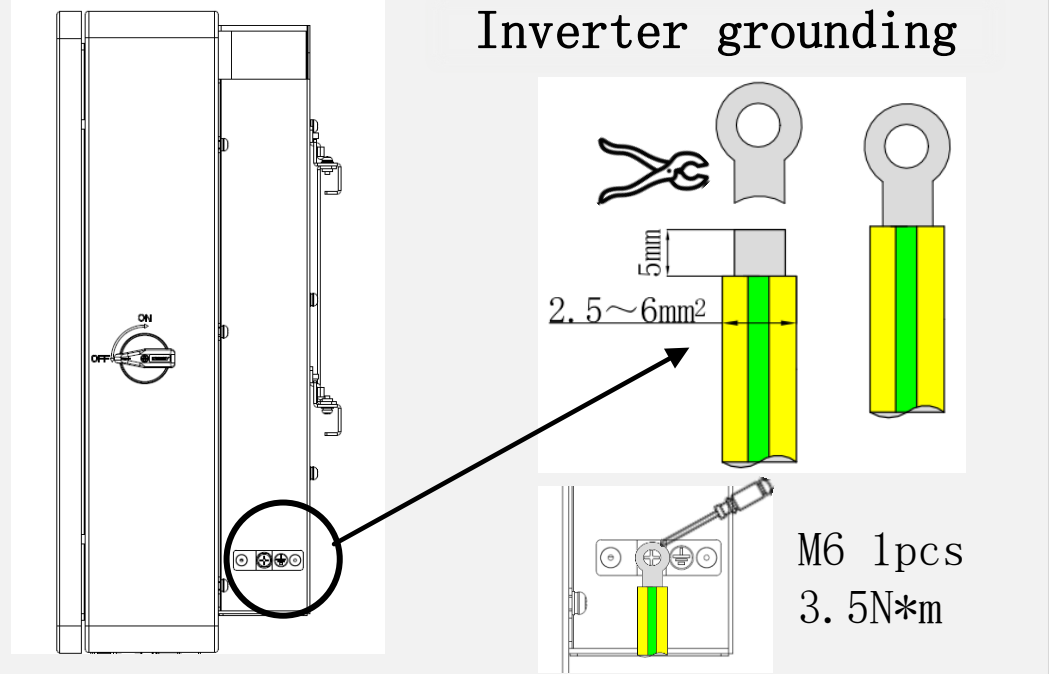

Connecting PV

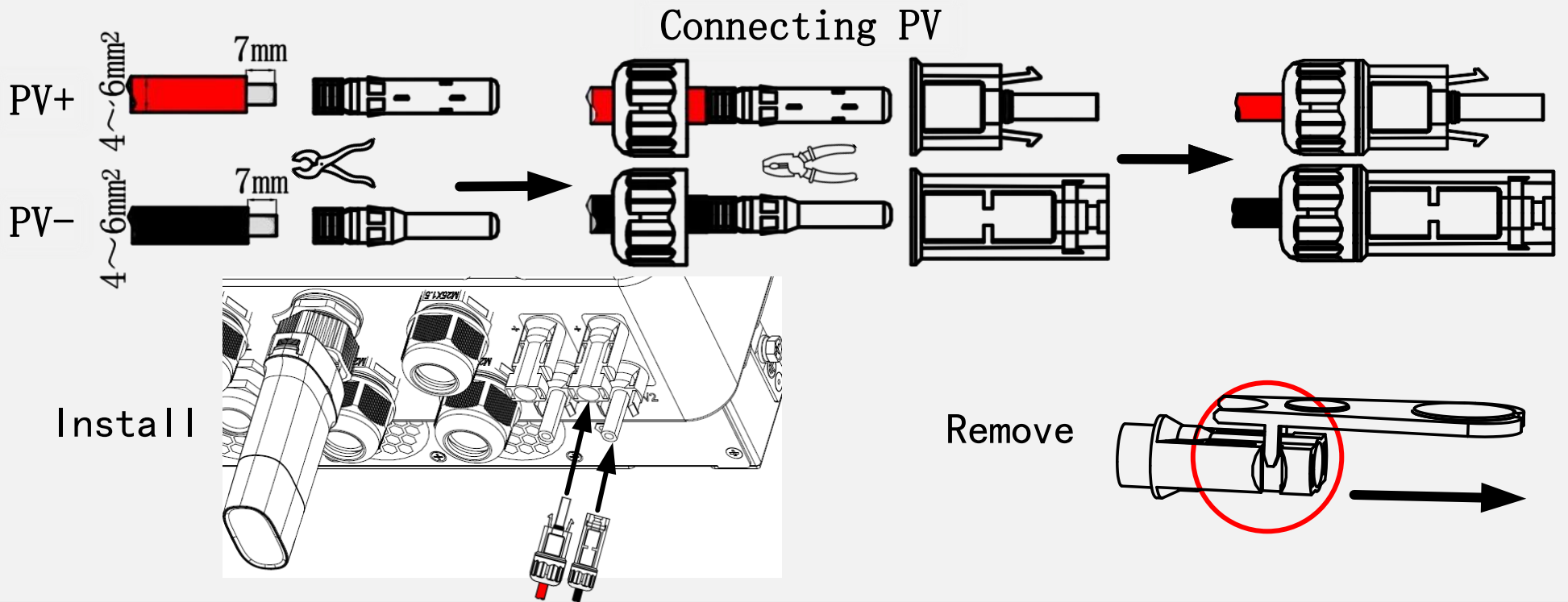

Connecting the WIFI module

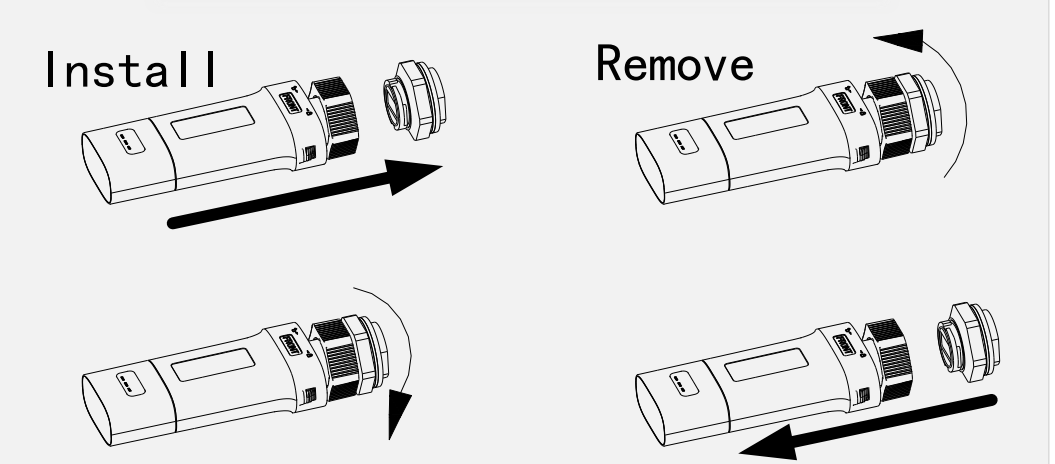

ESS Link Download

